



SEML SERIES - STEEL EMERGENCY LIGHTING

Heavy-Duty 20-Gauge Steel Dual-Head Emergency Battery Unit

FEATURES & SPECIFICATIONS TYPICAL SPECIFICATION

- Supply and install the SEML Series heavy-duty 20-gauge steel emergency lighting battery unit.
- The unit shall be UL 924 listed, as well as Chicago and New York Approved for use in jurisdictions requiring steel housing and stringent code compliance.
- The system shall operate with universal 120 to 347 VAC input and provide a minimum of 90 minutes of emergency illumination upon loss of AC power.
- The unit shall feature two top-mounted, fully adjustable 1.5W LED heads delivering a total of 250 lumens.
- The sign shall be CSA C22.2 No. 141-15 certified.



CONSTRUCTION

- **Material:** Robust 20-gauge steel housing, finished with a durable, corrosion-resistant white powder coat.
- **Design:** The back-plate contains a universal J-box mounting pattern for easy installation.
- **Heads:** Two high-performance LED lampheads with impact-resistant PC lenses.
- **Ambient Temperature:** Rated for damp locations at (0°C to 50°C/32°F to 122°F).

ELECTRICAL

- **Input:** Universal 120-347Vac, 50/60Hz.
- **Efficiency:** Ultra-low standby power consumption (1.1W) with a fully automatic, current-limiting charger to minimize operating costs.
- **Circuit Protection:** Integrated short-circuit protection and regulated charge voltage to ensure stable performance and maximize battery life.
- **Battery Safety:** Features AC Reset and Low Voltage Disconnect (LVD) to prevent battery damage from deep discharge.
- **Battery:** 3.6V AA 900mAh long-life, maintenance-free, rechargeable NiCd battery.

INSTALLATION

- **Mounting:** Back mount only.
- **Wiring Flexibility:** Features multiple side and top conduit knockouts to accommodate various field wiring requirements.

LISTINGS & COMPLIANCE

- **Safety Standard:** UL 924 listed.
- **Regional Approval:** Chicago and New York Approved.
- **Canadian Standards:** Listed and labeled to comply with CSA C22.2 No. 141-15.
- **Environmental:** Rated for Damp Locations.

PARAMETERS:

MODEL NO:	Input Ratings			Emergency Output:		Emergency Run Time	Recharge Time	Battery Pack	Operation Ambient	
SEMLW	120-347Vac	50/60Hz	0.018-0.01 Amps	1.1Watts	3.6Vdc	3Watts max	90Minutes	24Hours	NiCd 3.6V AA900mAh	0-50 °C damp locations

PRODUCT DIMENSIONS:

Specifications

Length: 242.4mm [9.54"]

Depth: 49.8mm [1.96"]

Height: 271.2mm [10.68"]

Weight: 1.41kg

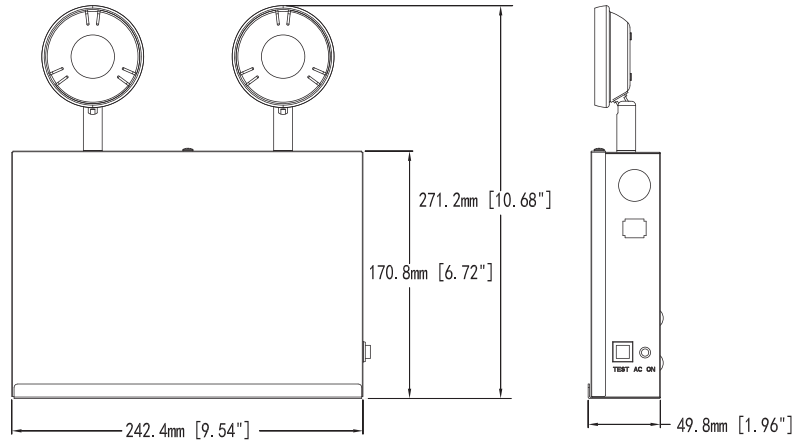

WIRING DIAGRAM:

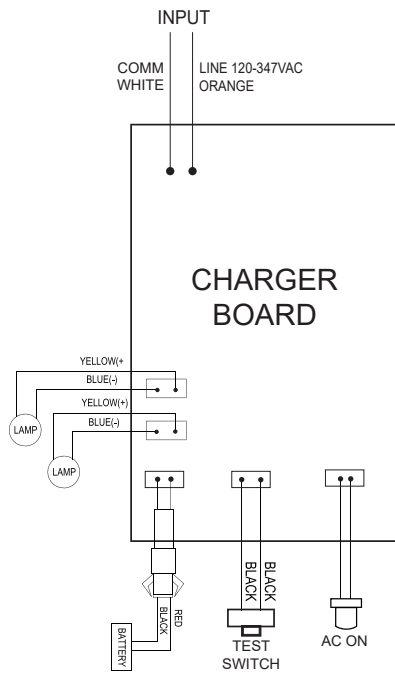

INDICATOR LIGHT:

Charging - Indicator light ON Green

Battery Disconnect(Connect AC power) - Indicator light ON Red

Emergency Mode - Indicator light OFF